

X-Axis Motor Replacement Fusion Pro 32 & 48

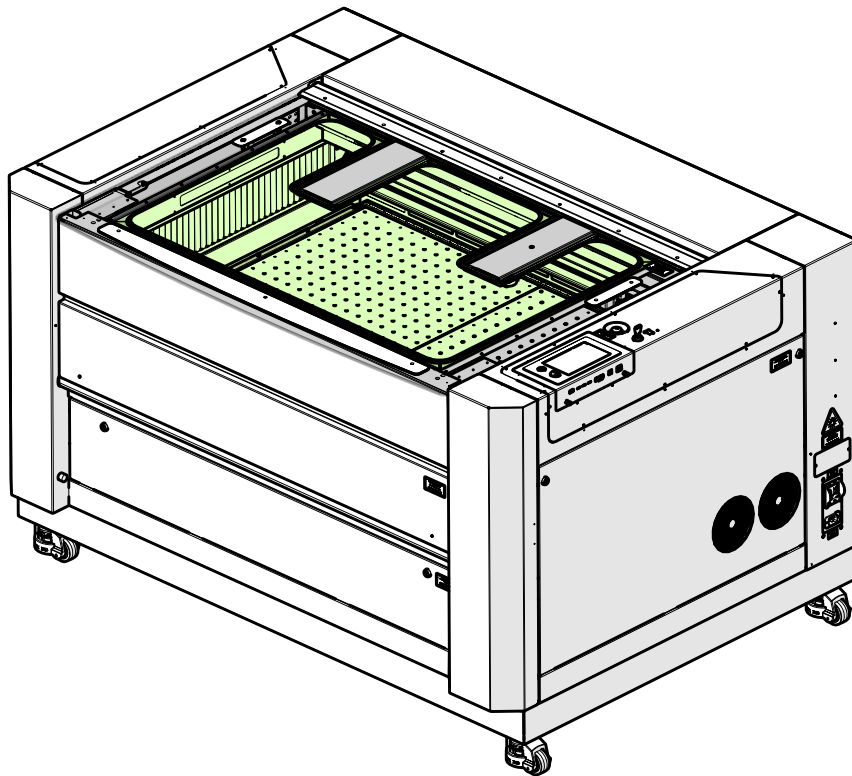

Required Parts

- CS0833 - X-axis motor

Required Tools

- 2.5 mm hex wrench
- 5/32" hex wrench
- Phillips head screwdriver

PRO 32 & 48 X-AXIS MOTOR

X-Axis Motor Removal

Turn off the engraver.

Disconnect the engraver from power.

Remove the right panel of the engraver:

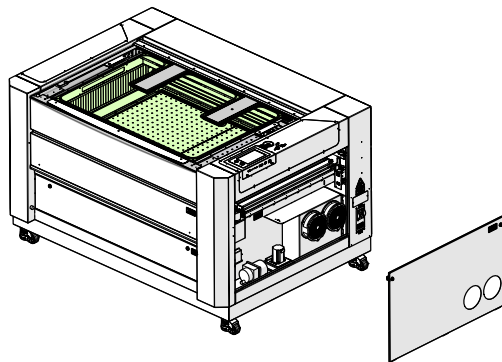

Manually move the x-axis assembly to the middle of the engraver:

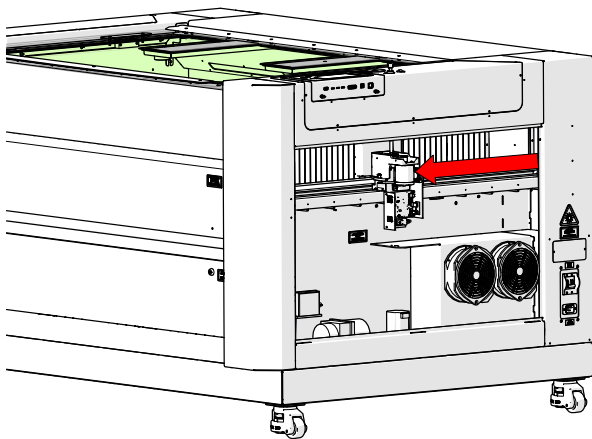

Loosen, but do not remove the four (4) Phillips screws that hold the x-axis motor drive board cover:

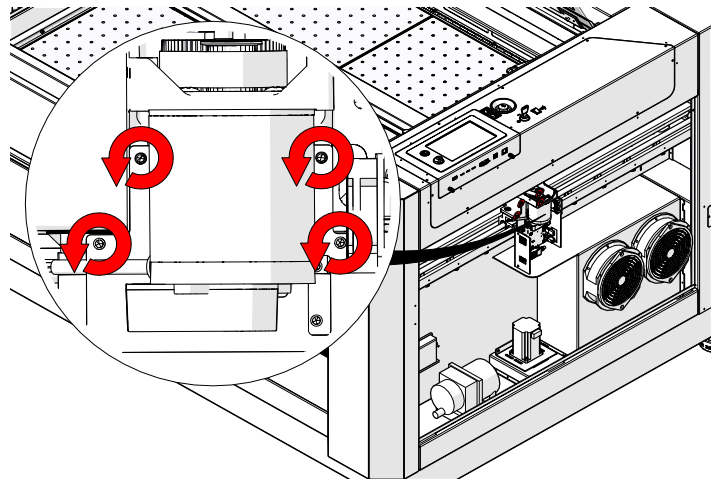

Remove the x-axis motor drive board cover.

Disconnect the three (3) x-axis motor electrical leads from the x-axis motor drive board:

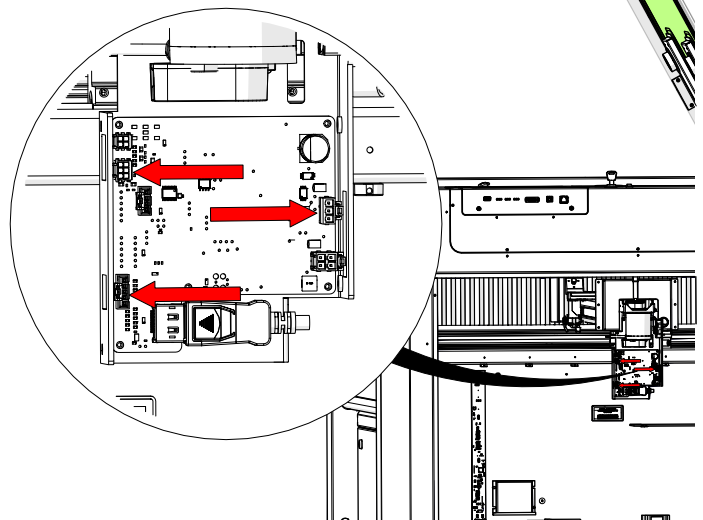

PRO 32 & 48 X-AXIS MOTOR

Loosen, but do not remove the four (4) 2.5mm Allen screws that secure the x-axis motor to the x-axis assembly:

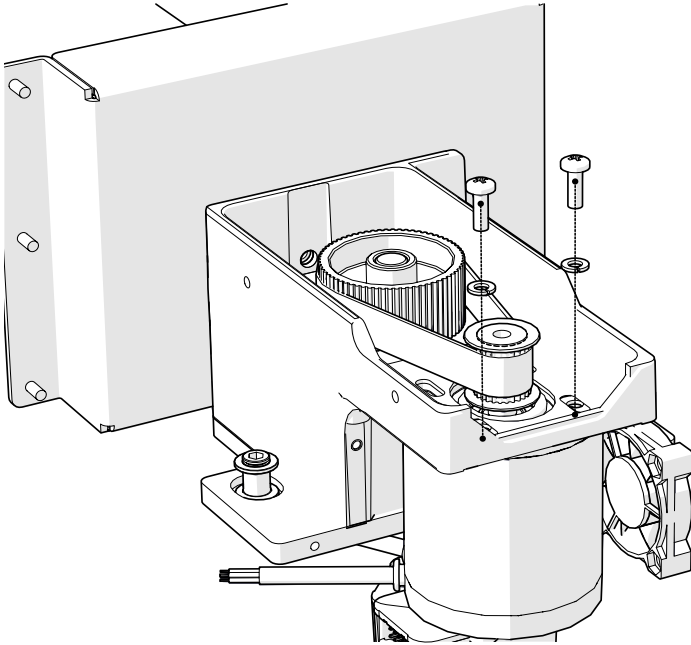

The image above shows two (2) Allen screws; however, there are four (4).

Remove the x-axis reducer belt from the x-axis assembly:

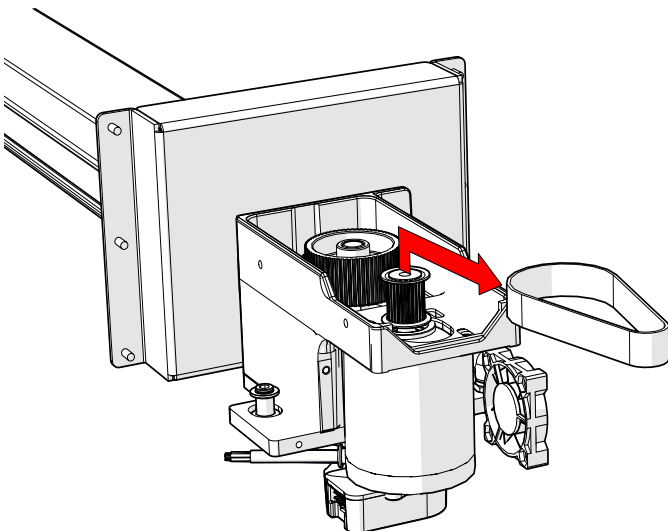

Remove the four (4) 2.5mm Allen screws that secure the x-axis motor to the x-axis assembly:

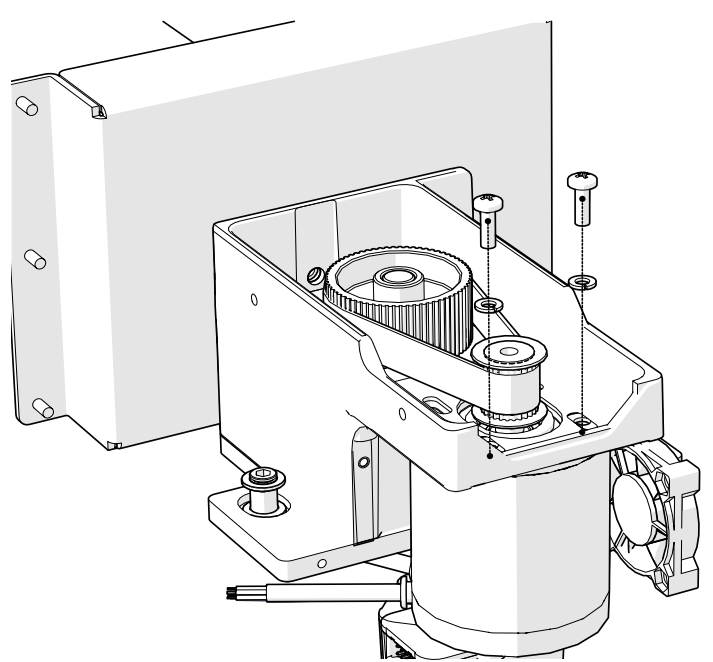

Remove the x-axis motor:

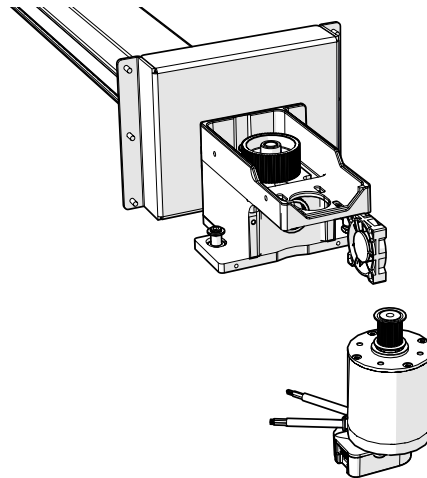

PRO 32 & 48 X-AXIS MOTOR

X-Axis Motor Installation

Place the x-axis motor into the x-axis assembly:

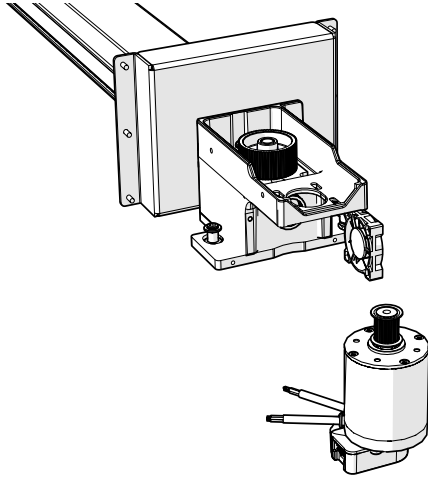

The x-axis encoder connection must face the front of the engraver as shown above. Any other orientation will prevent the engraver from booting up properly.

Install, but do not fully tighten the four (4) Allen screws that secure the x-axis motor to the x-axis assembly:

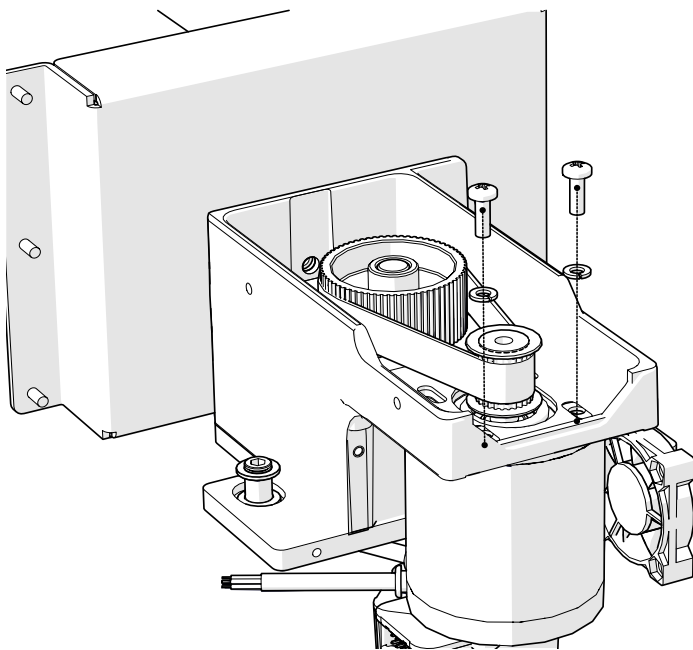

Install the x-axis reducer belt:

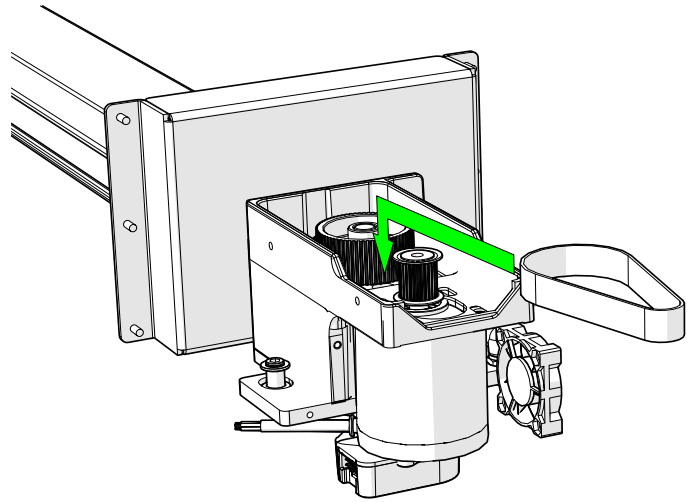

Apply tension to the x-axis reducer belt by pulling the motor away from the x-axis reducer pulley. Once the slack is removed from the reducer belt, fully tighten the four (4) 2.5mm Allen screws that hold the x-axis motor to the x-axis assembly.

Connect the three (3) x-axis motor electrical leads to the x-axis motor drive board:

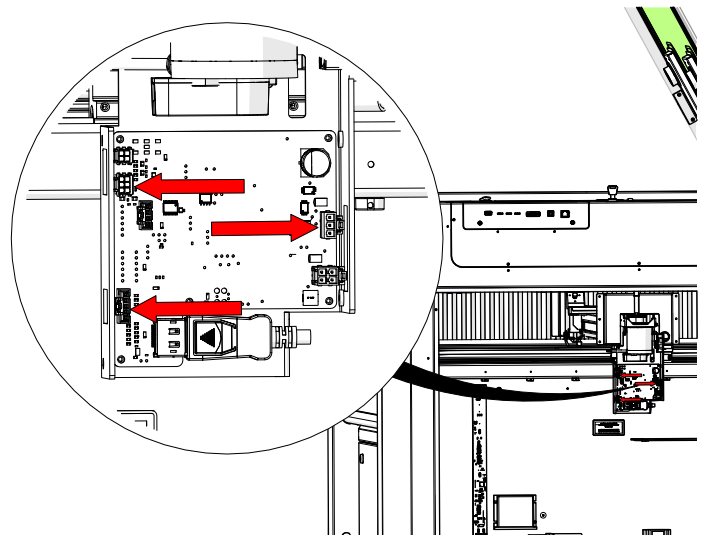

PRO 32 & 48 X-AXIS MOTOR

Replace the x-axis motor drive board cover and tighten the four (4) Phillips head screws:

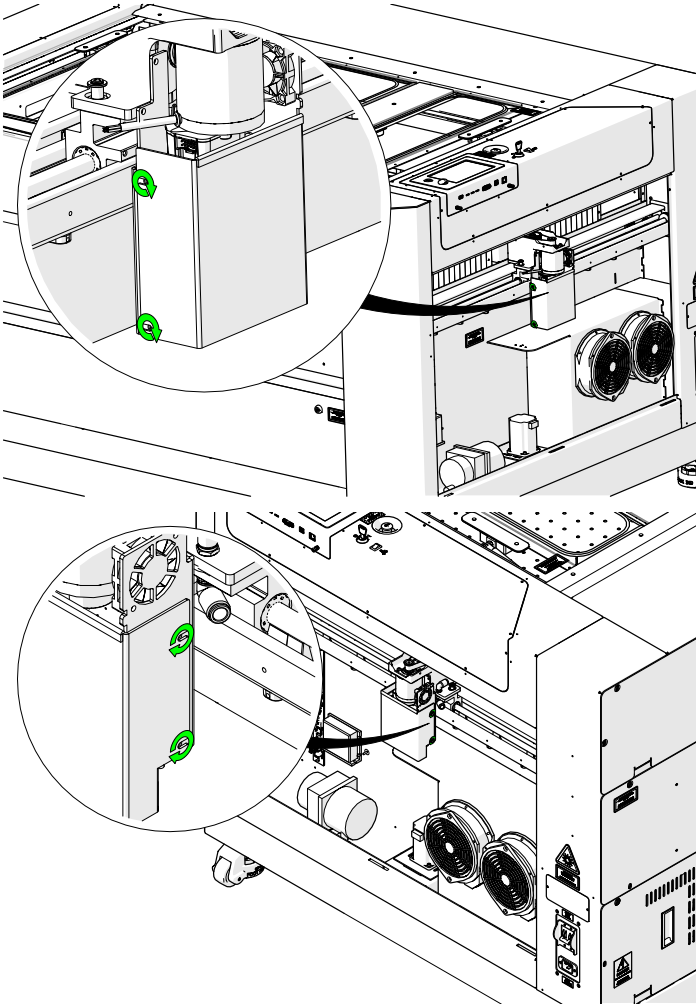

Replace the right side panel of the engraver.

Reconnect the engraver to power and boot up the machine, ensuring proper boot sequence.

If further assistance is required, reach out to Epilog Laser Tech Support by phone at 303-215-9171, or by email at tech@epiloglaser.com.

Programming the Motor

At the display panel, press the gear icon in the upper right-hand corner of the display to open the Settings menu:



Press Program to enter the Peripheral Update menu:



PRO 32 & 48 X-AXIS MOTOR

Once in the Peripheral Update menu, select Motor Drives and FPGA, then press Update:

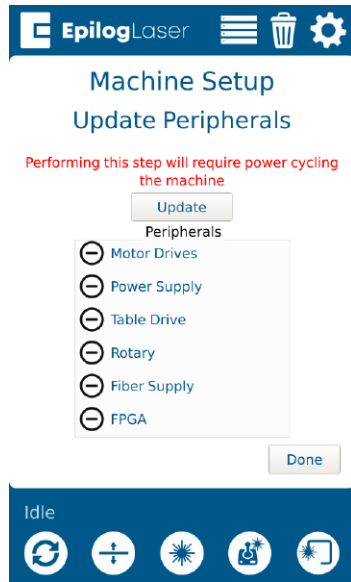

Allow the engraver to run the update process.

When running a peripheral update, do not power off the engraver. During a peripheral update it is common for the display to power off. Once the update has been applied, the engraver will prompt to restart.

Once the engraver prompts you to restart, power cycle the engraver.

If further assistance is required, reach out to Epilog Laser Tech Support by phone at 303-215-9171, or by email at tech@epiloglaser.com.